



HYDAC Technology Corporation

2260 City Line Road,

Bethlehem, PA 18017

TOLL FREE: [877-GO-HYDAC](tel:877-GO-HYDAC) (464-9322)

Website: www.hydac-na.com

VD: High Pressure Type CD: Electrical Switch

Early warning pressure devices protect the hydraulic circuit from contamination, alerting the operator that the filter element is near capacity and must be changed. The clogging indicator is typically set to trip at 1-bar (14 psid) below the filter bypass setting, to allow the operator sufficient time for element change-out. Available in visual, combo electrical/visual, as well as an extensive list of other options and certifications. A comprehensive offering of clogging indicators ensures that

[+ more](#)

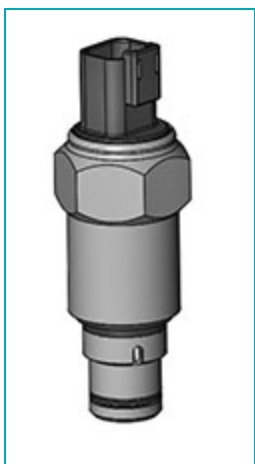

1

Part Number	Model Code Description	Type of Indication	Trip Pressure / Range	Operating Pressure [Max]	Thread	Medium	Maximum Torque
1325123	VD 8 CD.0 /-V- 2MO-40C	Electrical Switch	8 bar 116 psi	420 bar 6000 psi	G 1/2	Mineral Oil	74 lb·ft 100 N·m
1325124	VD 8 CD.0 /-V- 2MO- 40C-OE	Electrical Switch	8 bar 116 psi	420 bar 6000 psi	G 1/2	Mineral Oil	74 lb·ft 100 N·m

Part Number	Model Code Description	Type of Indication	Trip Pressure / Range	Operating Pressure [Max]	Thread	Medium	Maximum Torque
<u>1302711</u>	VD2CD.0/-2M0	Electrical Switch	2 bar 29 psi	420 bar 6000 psi	G 1/2	Mineral Oil	74 lb·ft 100 N·m
<u>2096179</u>	VD2CD.0/-2M0-OE	Electrical Switch	2 bar 29 psi	420 bar 6000 psi	G 1/2	Mineral Oil	74 lb·ft 100 N·m
<u>1289999</u>	VD5CD.0/-2M0	Electrical Switch	5 bar 72 psi	420 bar 6000 psi	G 1/2	Mineral Oil	74 lb·ft 100 N·m
<u>1295004</u>	VD5CD.0/-2M0-OE	Electrical Switch	5 bar 72 psi	420 bar 6000 psi	G 1/2	Mineral Oil	74 lb·ft 100 N·m
<u>1283394</u>	VD5CD.0/-2M20	Electrical Switch	5 bar 72 psi	420 bar 6000 psi	G 1/2	Mineral Oil	74 lb·ft 100 N·m
<u>1285348</u>	VD5CD.0/-2M20-OE	Electrical Switch	5 bar 72 psi	420 bar 6000 psi	G 1/2	Mineral Oil	74 lb·ft 100 N·m